

Left Perspective View

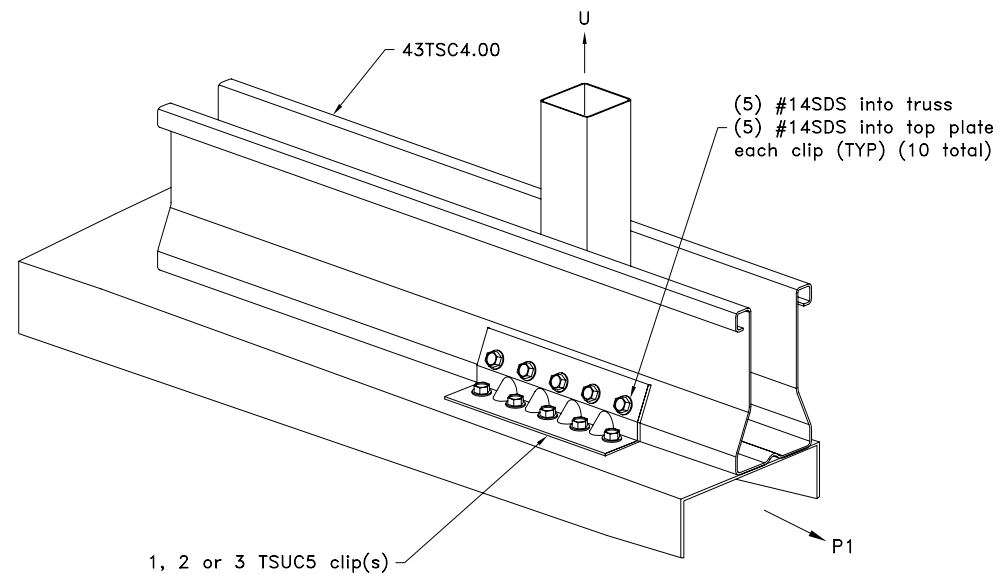

Right Perspective View

Maximum Loads in Combination *			
(1)TSCU5	U = 1,600 lbs	P <sub>1</sub> = 1,550 lbs	
(2)TSUC5	U = 400 lbs	P <sub>1</sub> = 4,200 lbs	
(3)TSUC5	U = 3,700 lbs	P <sub>1</sub> = 400 lbs	

\* Attachment of a single plate on opposite face of chord required

General Notes:

1. SDS = Self-Drilling Tapping Screw
2. All edge distance, end distance and spacing are 3/4" minimum.
3. Cold-Formed Steel Calculations are per the 2010 addendum to the AISI 2007 "North American Specifications for the design of Cold-Formed Steel Structural members" (S100-07/S2-10).
4. P<sub>1</sub> refers to the lateral reaction, U refers to the uplift.
5. Wall top plate shall be manufactured from Cold-Formed Steel (CFS) with minimum tensile strength of 45 KSI (310 MPa) and maximum width of 3-5/8".
6. The wall top plate is to be designed by the job engineer. The wall top plate must be designed to support the loads applied to it (downward, upward and lateral).

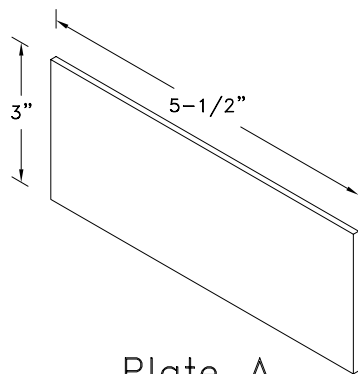

Plate A

14g ASTM A653 SS Grade 33 G60  
Bare Metal Thickness = t = 0.0677"



[www.TrusSteel.com](http://www.TrusSteel.com)

**Florida:** 1950 Marley Drive / Haines City, FL 33844 / (800) 755-6001  
**Missouri:** 13389 Lakefront Drive / Earth City, MO 63045 / (800) 326-4102  
**California:** 8351 Rovana Circle / Sacramento, CA 95828 / (800) 877-3678

## TSUC5 and Plate Attachment To Cold-Formed Steel

ITW Building Components Group, Inc. shall not be responsible for any performance failure in a connection due to a deviation from this detail. Any variation from this detail shall be approved in advance by ITW Building Components Group, Inc.

**Custom Detail:**  
TS-CD-TB-CF18-001

**Date:**  
07/11/11

**Custom Detail:**  
Truss-To-Bearing: All other Materials